

Daikin air conditioners floor standing unit

Daikin Airconditioning UK Ltd



www.daikin.co.uk

FVKS/FVXS-B





This Floor Standing unit can be used for floor standing or lower wall applications. As a floor standing model, it can be semi-recessed or fully recessed without loss of capacity.

COMFORT

- The **vertical auto swing** automatically moves the flaps up and down to ensure an even distribution of air throughout the room.

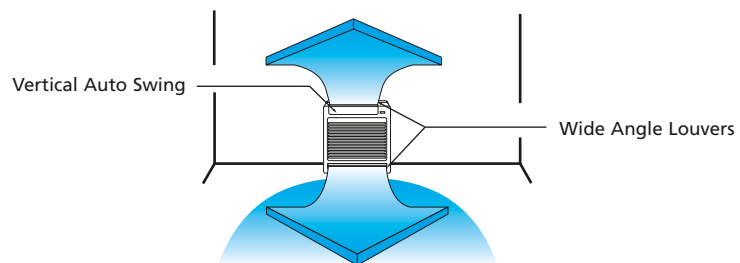

- The smoothly curved **wide angle louvers** provide wide air flow coverage for effective cooling operation no matter where the indoor unit is placed in the room. The louvers can be manually adjusted.

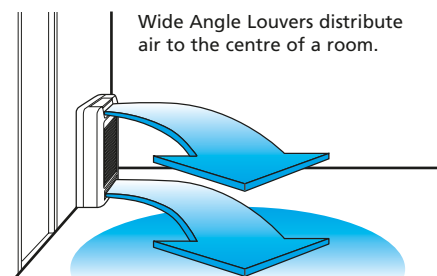

- You have the choice of **5 fan speeds** to select: from high to super low.
- Daikin's special **dry programme** reduces humidity in the room without variations in room temperature.
- The **powerful operation** function boosts the air flow to a maximum volume for a 20-minute period, (e.g. when you come home on a hot day, rapid cooling is required). After this, the unit returns automatically to its previous settings.

- The **night set mode** is automatically selected by pushing the 'off' timer button. This function prevents any sudden change in room temperature by gently raising/lowering the temperature before the air conditioner stops, so you can sleep more comfortably.
- The indoor unit is **very quiet in operation**. The sound levels are as low as 28dB(A), comparable to rustling leaves.
- The **outdoor unit silent operation** function increases comfort by automatically lowering the operating sound of the outdoor unit by 3dB(A).
- The **night quiet mode** reduces the operating sound of the outdoor unit by another 3 dB(A) at night (Multi models only).

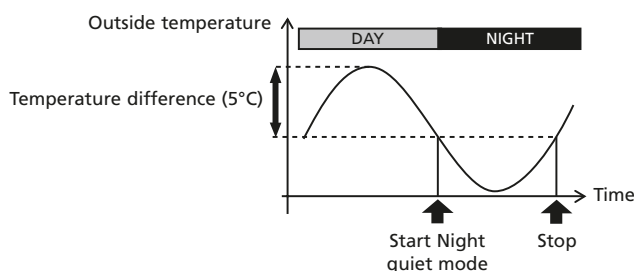

FILTER

- This floor standing unit is equipped with a **separate air purification filter and a photocatalytic deodorising filter**.

The air purification filter traps mildew, mites, tobacco smoke, dust and pollen as fine as 0.01 microns.

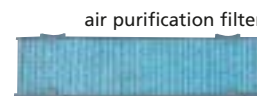

The photocatalytic deodorising filter decomposes odours and even deactivates bacteria and viruses. This capability is maintained simply by exposing the filter to sunlight once every 6 months. This filter does not need any replacement.



FLEXIBLE INSTALLATION AND EASY TO USE AND MAINTAIN

- The outdoor unit can be installed on a roof or terrace or placed against an outside wall.
- Daikin remote controls give you **easy control at your fingertips**.
- Malfunction codes are shown on the digital display panel of the infrared remote control for **fast and easy maintenance**.
- Special anti-corrosion treatment of the outdoor unit's heat exchanger fin gives **great resistance against acid rain and salt corrosion**. Additional resistance is provided by a rust proof steel sheet on the underside of the unit.



Infrared remote control (Standard)

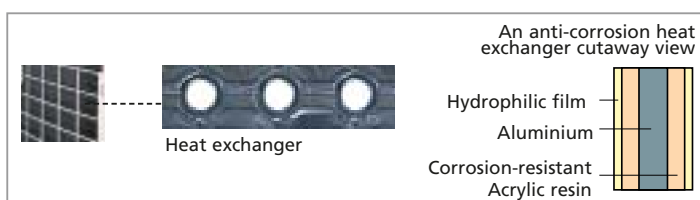

ENERGY EFFICIENT

- Energy label: up to class A
- **Inverter technology:**
Improved energy efficiency:
The use of integrated inverter control ensures maximum **energy efficiency** by supplying only the required heating or cooling load where a standard non inverter unit would supply maximum load in an on/off regime.

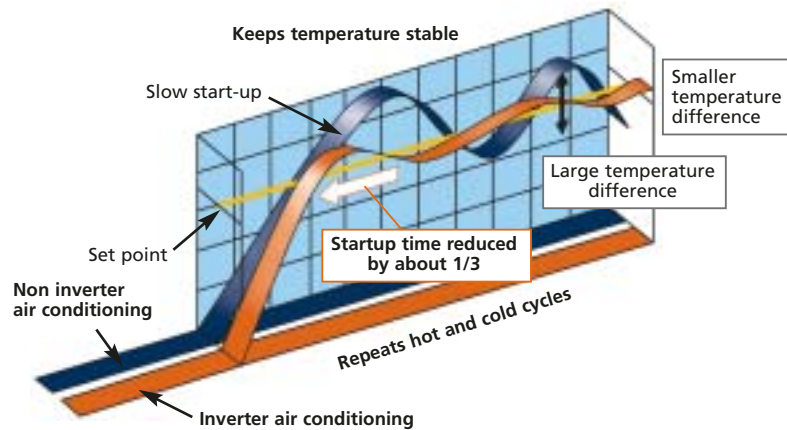

- Improved comfort:
The rapid start up time provided by the inverter increases the **comfort** by reducing the lead time in obtaining the required indoor temperature. Once the required temperature is reached, the inverter unit continuously scans the room for small changes and adjusts the room temperature in seconds. Thereby thus increasing comfort again.
- The **home leave operation** button prevents large temperature differences by continuously operating at a minimum (heating mode) or maximum (cooling mode) preset level while you're out or sleeping. It also allows the indoor temperature to return quickly to your favourite comfort level.

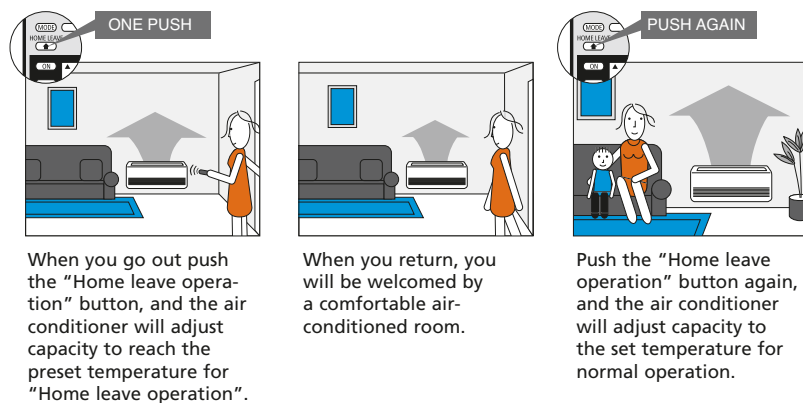

APPLICATION OPTIONS

- This model can be used for cooling only or heating.
- It is possible to use the indoor unit in pair (connecting one indoor to one outdoor) and multi applications (connecting up to 9 units in several rooms to 1 outdoor unit).

Capacity and power input

| COOLING ONLY - INVERTER / NON-INVERTER CONTROLLED (air cooled) | | | | FVKS25BVMB | FVKS35BVMB | FVKS50BVMB | FVKS50BVMB |
|--|-------------|-------------|-----|-------------|-------------|----------------|-------------|
| | | | | RKS25DVMB | RKS35DVMB | RKS50BVMB9 | RS50BVMB |
| Cooling capacity | min~nom~max | | kW | 2.50 (nom.) | 3.50 (nom.) | 0.90~4.80~5.30 | 4.80 (nom.) |
| Nominal input | min~nom~max | | kW | 0.70 (nom.) | 1.09 (nom.) | 0.45~1.70~2.35 | 1.70 (nom.) |
| EER | | | | 3.57 | 3.21 | 2.82 | 2.82 |
| Energy label | | | | A | A | C | C |
| Annual energy consumption | cooling | | kWh | 350 | 545 | 850 | 850 |
| HEAT PUMP - INVERTER CONTROLLED (air cooled) | | | | FVXS25BVMB | FVXS35BVMB | FVXS50BVMB | |
| | | | | RXS25DVMB | RXS35DVMB | RXS50BVMB | |
| Cooling capacity | min~nom~max | | kW | 2.50 (nom.) | 3.50 (nom.) | 0.90~4.80~5.30 | |
| Heating capacity | min~nom~max | | kW | 3.40 (nom.) | 4.50 (nom.) | 0.90~6.00~7.70 | |
| Nominal input | cooling | min~nom~max | kW | 0.70 (nom.) | 1.09 (nom.) | 0.45~1.70~2.35 | |
| | heating | min~nom~max | kW | 0.90 (nom.) | 1.32 (nom.) | 0.31~1.87~2.60 | |
| EER | | | | 3.57 | 3.21 | 2.82 | |
| COP | | | | 3.78 | 3.41 | 3.21 | |
| Energy label | cooling | | | A | A | C | |
| | heating | | | A | B | C | |
| Annual energy consumption | cooling | | kWh | 350 | 545 | 850 | |

Note :

- 1) Energy label: scale from A (most efficient) to G (less efficient).
- 2) Annual energy consumption: based on average use of 500 running hours per year at full load (=nominal conditions)
- 3) The Energy Label Directive 2002/31/EC will enter into force once the relevant measurement standard will be published in the European Official Standard.

| MULTI - COOLING ONLY | Max. n° of indoor units | Max. cooling capacities (kW) | Max. PI cooling (kW) | | |
|------------------------------|-------------------------|------------------------------|----------------------|------------------------------|----------------------|
| 3MKS50D | 3 | 6.46 | 2.25 | | |
| 4MKS58D | 4 | 6.60 | 2.47 | | |
| 4MKS75D | 4 | 9.27 | 3.71 | | |
| 4MKS90D | 4 | 9.86 | 3.52 | | |
| MULTI - HEAT PUMP | Max. n° of indoor units | Max. cooling capacities (kW) | Max. PI cooling (kW) | Max. heating capacities (kW) | Max. PI heating (kW) |
| 2MXS52D* | 2 | 6.50 | 2.69 | 7.34 | 2.42 |
| 3MXS52D* | 3 | 6.50 | 2.69 | 7.34 | 2.42 |
| 4MXS68D* | 4 | 8.68 | 3.69 | 10.64 | 3.41 |
| 4MXS80D* | 4 | 9.49 | 3.34 | 11.00 | 3.52 |
| SUPER MULTI PLUS - HEAT PUMP | Max. n° of indoor units | Max. cooling capacities (kW) | Max. PI cooling (kW) | Max. heating capacities (kW) | Max. PI heating (kW) |
| RMXS112D* | 7 | 11.20 | 3.57 | 12.50 | 4.01 |
| RMXS140D* | 8 | 14.00 | 5.23 | 16.00 | 5.31 |
| RMXS160D* | 9 | 15.50 | 5.55 | 17.50 | 5.56 |

Notes:

- For more detailed information about specifications, capacities, power input, energy labelling and annual energy consumption, please refer to our Multi Model / Super Multi Plus catalogue or check with your local dealer.
- * At least 2 indoor units should be connected to this Multi outdoor unit.

Indoor units: FVK/XS-B



FVK/XS25,35,50BVMB

Specifications indoor units

| COOLING ONLY | | | | FVK525BVM | FVK535BVM | FVK550BVM |
|----------------------|-------------|--------|---------------------|---------------------------|-------------|--------------|
| Dimensions | HxWxD | | mm | 600x650x195 | | |
| Weight | | | kg | 13 | 13 | 13 |
| Front panel colour | | | | almond white | | |
| Air flow rate | H/L/SL | | m ³ /min | 8.1/4.3/3.4 | 8.3/4.3/3.4 | 10.8/7.7/6.7 |
| Fan speed | | | steps | 5 steps, silent and auto | | |
| Sound pressure level | H/L/SL | | dB(A) | 38/26/23 | 39/27/24 | 44/36/33 |
| Sound power level | H | | dB(A) | 54 | 55 | 56 |
| Piping connections | liquid | | mm | ø6.4 | | |
| | gas | | mm | ø9.5 | | |
| | drain | | mm | ø18.0 | | |
| Heat insulation | | | | both liquid and gas pipes | | |
| HEAT PUMP | | | | FVXS25BVM | FVXS35BVM | FVXS50BVM |
| Dimensions | HxWxD | | mm | 600x650x195 | | |
| Weight | | | kg | 13 | 13 | 13 |
| Front panel colour | | | | almond white | | |
| Air flow rate | cooling | H/L/SL | m ³ /min | 8.1/4.3/3.4 | 8.3/4.3/3.4 | 10.8/7.7/6.7 |
| | heating | H/L/SL | m ³ /min | 9.2/4.8/3.5 | 9.2/5.0/3.6 | 13.2/9.4/8.3 |
| Fan speed | | | steps | 5 steps, silent and auto | | |
| Sound pressure level | cooling | H/L/SL | dB(A) | 38/26/23 | 39/27/24 | 44/36/33 |
| | heating | H/L/SL | dB(A) | 38/26/23 | 39/29/26 | 45/36/33 |
| Sound power level | cool./heat. | H | dB(A) | 54/* | 55/* | 56/57 |
| Piping connections | liquid | | mm | ø6.4 | | |
| | gas | | mm | ø9.5 | | |
| | drain | | mm | ø18.0 | | |
| Heat insulation | | | | both liquid and gas pipes | | |

* This information was not available at the time of publication.

Specifications outdoor units

| COOLING ONLY - INVERTER / NON-INVERTER CONTROLLED | | | | RKS25DVM | RKS35DVM | RKS50BVM9 | RS50BVM |
|---|-----------|-----------|-------|---|----------|--|--|
| Dimensions | HxWxD | | mm | 550x765x285 | | 735x825x300 | 735x825x300 |
| Weight | | | kg | 30 | 32 | 49 | 49 |
| Casing colour | | | | Ivory white | | Ivory white | Ivory white |
| Sound pressure level | H/L | | dB(A) | 46/43 | 47/44 | 47/* | 47/* |
| Sound power level | H | | dB(A) | 61 | 62 | 63 | 63 |
| Compressor | | | | hermetically sealed swing type | | hermetically sealed swing type | hermetically sealed swing type |
| Refrigerant type | | | | R-410A | | R-410A | R-410A |
| Refrigerant charge | | | kg/m | 0.02 (for piping length exceeding 10m) | | 0.02 (for piping length exceeding 10m) | 0.02 (for piping length exceeding 10m) |
| Maximum piping length | | | m | 20 | | 30 | 30 |
| Maximum level difference | | | m | 15 | | 20 | 20 |
| Operation range | from ~ to | | °CDB | -10~46 | | -10(-15)*~46 | +10~46 |
| HEAT PUMP - INVERTER CONTROLLED | | | | RXS25DVM | RXS35DVM | RXS50BVM | |
| Dimensions | HxWxD | | mm | 550x765x285 | | 735x825x300 | |
| Weight | | | kg | 30 | 32 | 49 | |
| Casing colour | | | | Ivory white | | Ivory white | |
| Sound pressure level | cooling | H/L | dB(A) | 46/43 | 47/44 | 47/* | |
| | heating | H/L | dB(A) | 47/44 | 48/45 | 48/* | |
| Sound power level | cooling | H | dB(A) | 61 | 62 | 63 | |
| | heating | H | dB(A) | 62 | 63 | 64 | |
| Compressor | | | | hermetically sealed swing type | | hermetically sealed swing type | |
| Refrigerant type | | | | R-410A | | R-410A | |
| Refrigerant charge | | | kg/m | 0.02 (for piping length exceeding 10m) | | 0.02 (for piping length exceeding 10m) | |
| Maximum piping length | | | m | 20 | | 30 | |
| Maximum level difference | | | m | 15 | | 20 | |
| Operation range | cooling | from ~ to | °CDB | -10~46 | | -10~46 | |
| | heating | from ~ to | °CWB | -15~20 | | -15~20 | |

* This information was not available at time of publication.

** Possibility to extend the operation range down to -15°C by turning ON the switch on the outdoor unit PCB. In this case, the unit will stop operation at -20°C or lower and will recover when temperature rises again.

Accessories: control systems

| INDOOR UNITS | | FVK/XS25B | FVK/XS35B | FVK/XS50B |
|--|---------------------------|-----------|-----------|-----------|
| Wiring adapter for time clock/ remote control (1) | normal open contact | | KRP413A1S | |
| | normal open pulse contact | | KRP413A1S | |
| Centralised control board | up to 5 rooms (2) | | KRC726 | |
| Central remote control | | | DCS302C51 | |
| Unified ON/OFF control | | | DCS301B51 | |
| Schedule timer | | | DST301B51 | |
| Interface adapter (3) | | | KRP928A2S | |

(1) Wiring adapter is supplied by Daikin. Timer and other devices: field supply.

(2) Wiring adapter is also required for each indoor unit.

(3) For DIII-NET adapter

Accessories

| INDOOR UNITS | | FVK/XS25B | FVK/XS35B | FVK/XS50B |
|--|--|-----------|-----------|-----------|
| Photocatalytic deodorising filter, with frame | | | KAZ917A41 | |
| Photocatalytic deodorising filter, without frame | | | KAZ917A42 | |
| Air purification filter, with frame | | | KAF925B41 | |
| Air purification filter, without frame | | | KAF925B42 | |
| Anti-theft protection for remote control | | | KKF917A4 | |

Accessories

| OUTDOOR UNITS | | RK/XS25D | RK/XS35D | RK/XS/RS50B |
|---------------------------------|--|----------|----------|-------------|
| Air direction adjustment grille | | KPW937A4 | | KPW945A4 |

Note:

1) VM = 1 ~, 220-240/220-230V, 50Hz/60Hz

2) Nominal cooling capacities are based on: indoor temperature 27°CDB/19°CWB • outdoor temperature 35°CDB • refrigerant piping length 7.5m • level difference 0m.

3) Nominal heating capacities are based on: indoor temperature 20°CDB • outdoor temperature 7°CDB/6°CWB • refrigerant piping length 7.5m • level difference 0m.

4) Capacities are net, including a deduction for cooling (an addition for heating) for indoor fan motor heat.

5) Units should be selected on nominal capacity. Max. capacity is limited to peak periods.

6) The sound pressure level is measured via a microphone at a certain distance from the unit (for measuring conditions; please refer to the technical databooks).

7) The sound power is an absolute value indicating the "power" which a sound source generates.





In all of us,
a green heart.



Daikin's unique position as a manufacturer of air conditioning equipment, compressors and refrigerants has led to its close involvement in environmental issues. For several years Daikin has had the intention to become a leader in the provision of environmental friendly products. This challenge demands the eco design and development of a wide range of products and an energy management system; which involves energy conservation and reduction of waste.



Daikin Europe N.V. is approved by LRQA for its Quality Management System in accordance with the ISO9001 standard.

ISO9001 pertains to quality assurance regarding design, development, manufacturing as well as to services related to the product.



ISO14001 assures an effective environmental management system in order to help protect human health and the environment from the potential impact of our activities, products and services and to assist in maintaining and improving the quality of the environment.



Daikin units comply with the European regulations that guarantee the safety of the product.



Daikin Europe N.V. is participating in the EUROVENT Certification Programme. Products are as listed in the EUROVENT Directory of Certified Products. Multi units are Eurovent certified for combinations up to 2 indoor units.

Specifications are subject to change without prior notice.

Head office

Daikin Airconditioning UK limited

1 River Court, Albert Drive, Woking, Surrey GU21 5RP
Tel 01483 711810 Fax 01483 711890

Administration centres

4 Wells Place, Merstham, Redhill, Surrey RH1 3DR
Tel 01737 732345 Fax 01737 644054

Airways, Midland Way, Thornbury, Bristol BS35 2JX
Tel 01454 281000 Fax 01454 415199

1 Wellington Road, Bishopbriggs, Glasgow G64 2SA
Tel 0845 6021122 Fax 0845 6052233

Daikin products are distributed by:

