

# Clarke®

## air



## AIR COMPRESSOR KIT 230V MODEL NO: MONZA

PART NO: 1498500

## OPERATION & MAINTENANCE INSTRUCTIONS



ORIGINAL INSTRUCTIONS

GC0321 - rev 1

---

## INTRODUCTION

---

Thank you for purchasing this CLARKE Air Compressor kit.

The Monza is designed to be used for compressed-air driven tools which can be driven with an air volume of up to approx 180 L/min (e.g. tyre inflator, blow gun and paint spray guns such as the CLARKE JSC spray gun etc). A suitable CLARKE male adaptor will need to be obtained.

Before attempting to operate the product it is essential that you read this manual thoroughly and carefully follow all instructions given. In doing so you will ensure the safety of yourself and that of others around you, and you can also look forward to the product giving you long and satisfactory service.

---

## SPECIFICATIONS

---

Model	Monza
Part No	1498500
Power supply	230 V / 50 Hz
Dimensions (L x W x H)	435 x 340 x 140 mm
Ingress Protection class	IP20
Insulation class	II
Weight	5.77 kg
Duty cycle	S3 /15% (1.5 min on/8.5 min off)
Extending cable length	5.3M
Gauge maximum pressure	12 Bar/170 psi
Max working pressure	8 Bar/116 psi
Max flow rate	180L/min (6.35 CFM)
Operating temperature	+5°+40°C
Sound power level	93.7 dB LwA
Sound pressure level	77 dB LpA
Guaranteed Sound Power Level	97 dB LwA

---

## GENERAL SAFETY WARNINGS

---



**WARNING: WHEN USING ELECTRICAL TOOLS, BASIC SAFETY PRECAUTIONS SHOULD ALWAYS BE FOLLOWED TO REDUCE THE RISK OF FIRE, ELECTRIC SHOCK AND PERSONAL INJURY**

**WARNING: READ ALL THESE INSTRUCTIONS BEFORE ATTEMPTING TO USE THIS PRODUCT AND KEEP THESE INSTRUCTIONS IN A SAFE PLACE.**

---

### WORK AREA

1. **Keep the work area clean and well lit.** Floors should always be kept clear. Cluttered or dark areas invite accidents.
2. **Keep children and bystanders away while operating a power tool.** Distractions can cause loss of control.
3. The compressor should only be used in areas with adequate ventilation and should not be exposed to heat or used near flammable substances

### PERSONAL SAFETY

1. **ALWAYS** stay alert, watch what you are doing and use common sense when operating the compressor. **DO NOT** use the compressor while you are tired or under the influence of medication, drugs or alcohol. A moment of inattention can result in personal injury.
2. **ALWAYS** use eye protection when operating compressed air equipment, and ensure that others in the work area are protected from flying particles from the front and from the side.
3. **ALWAYS** protect yourself against electric shock. Never operate the compressor in wet or damp locations.
4. **NEVER** over-reach. Keep your proper footing and balance at all times to enable better control of the compressor in unexpected situations.
5. **NEVER** attempt any complex repairs yourself. If you have a technical problem contact your local CLARKE dealer.
6. **ALWAYS** store the compressor out of reach of children.
7. **ALWAYS** protect your hearing. Ear protection should be worn when operating this compressor.
8. **NEVER** direct the air stream at people or animals as injury may result. Compressed air can cause soft tissue damage and propel dirt and other particles at high speed.
9. **NEVER** insert your fingers or other objects inside the motor housing. **NEVER** operate the compressor without the cover in place.

## GENERAL MACHINE USE AND CARE

1. Prior to use, all operators should become familiar with the instructions in this booklet especially the ON/OFF switch for emergency stopping.
2. **ALWAYS** maintain the compressor with care and keep it clean for best / safest performance.
3. **NEVER** use this compressor if any part is damaged. Have it inspected and repaired by your CLARKE dealer.
4. **NEVER** attempt to modify the air compressor, fittings or attachments in any way. Doing so will invalidate the guarantee and could result in personal injury.
5. **NEVER** abuse the power cable. **NEVER** pull on the cable when removing the plug from the socket, or lift the compressor by the power cable.
6. **ONLY** use extension leads that are of an appropriate power rating and suitable for the work environment. Extension leads must have an earth connection. Inspect the extension lead regularly and replace if damaged.
7. **ONLY USE RECOMMENDED PARTS:** To avoid the risk of bursting, only hoses with a rated pressure of 8 bar or more should be used. **NEVER** attempt to repair damaged hoses.
8. **NEVER** abuse the compressor by standing on it.

## AIRLINE HOSES







1. **ALWAYS** ensure that equipment or power tools used in conjunction with the compressor have a safe working pressure exceeding that of the machine.
2. **ALWAYS** keep the air hose away from any attached power tools and ensure that the operator is not restricted by the length of the hose.
3. **ALWAYS** take care when a long air hose is required in the work area as it presents a trip hazard. Coil the hose away as soon as the job is finished.
4. **ALWAYS** avoid kinking or trapping the air hose. **ALWAYS** replace damaged hoses and never attempt a repair if a leak is detected.
5. **NEVER** abuse hoses or connectors. **NEVER** carry an air tool by the hose, or yank it to disconnect from the air supply. Keep hoses away from heat, oil and sharp edges. Check hoses for leaks or worn condition before use and ensure that all connections are secure.
6. **ALWAYS** ensure that the air supply is turned off at the machine outlet and any air pressure vented from within the compressor and any attached equipment when disconnecting air hoses or other equipment.

## AIR COMPRESSOR SAFETY INSTRUCTIONS

1. **ONLY USE WITHIN THE RECOMMENDED OPERATING TEMPERATURE RANGE:**  
This compressor should only be used in an ambient temperature of between +5°C and +40°C. (**NEVER** use below freezing temperatures).
2. **NEVER USE AN AIR COMPRESSOR WHICH APPEARS DEFECTIVE OR IS OPERATING ABNORMALLY:** If the compressor operates unusually or makes strange noises, switch off immediately. Arrange repairs with your nearest CLARKE dealer.
3. **BREATHING QUALITY AIR:** This compressor should not be used to supply breathing quality air.
4. **AVOID UNINTENTIONAL STARTING: DO NOT** move the compressor when it is connected to the mains power supply.
5. **BEFORE EACH USE CHECK THE COMPRESSOR AND HOSE FOR DAMAGE:**  
**NEVER** use the compressor if it has been damaged in any way. Have the compressor repaired by a qualified service engineer. **DO NOT** use the compressor if the On/Off switch does not operate correctly.
6. **KEEP THE MOTOR AIR VENTS CLEAR:** Keep the motor air vents clear and free from dust. Wipe regularly to maintain an adequate supply of air and avoid using in dusty conditions.
7. **OPERATE THE COMPRESSOR AT THE CORRECT VOLTAGE:** Make sure that the mains supply voltage is the same as the voltage shown on the label.
8. When using the compressor for spray painting:
  - **DO NOT** work in enclosed areas or near naked flames.
  - Ensure that the area in which you are working has good ventilation.
  - Protect your nose and mouth with a suitable face mask.
  - **ALWAYS** check the safety data sheets for substances being sprayed & ensure manufacturer's instructions are followed.
9. **TAKE CARE WHEN USING THIS COMPRESSOR TO INFLATE SMALL, LOW-PRESSURE OBJECTS:** Items such as children's toys or footballs can explode if over-inflated.
10. **NEVER STOP THE COMPRESSOR BY REMOVING THE PLUG OR SWITCHING OFF AT THE MAINS SUPPLY: ALWAYS** use the On/Off switch on the compressor first.

## SAFETY SYMBOLS

The following safety symbols are shown on the product and/or it's packaging. Please read all of the safety and operating instructions carefully before using this product.

	<p>Read this instruction booklet carefully before positioning, operating or adjusting the compressor.</p>
	<p>Safety goggles should be worn</p>
	<p>Ear defenders should be worn.</p>
 <p>LWA</p> <p><b>97</b> dB</p>	<p>This compressor produces a high sound level during operation. Ear protection should be worn.</p>
	<p>Risk of accidental start-up. The compressor could start automatically in the event of a power cut and subsequent reset. Do not carry the compressor while it is connected to the power source.</p>
	<p>Risk of electric shock. The compressor must be disconnected from the mains supply before removing any covers. Do not use in a damp environment.</p>
	<p>This compressor should never be stopped suddenly by unplugging from the mains supply. This increases the risk of accidental startup.</p>

# ELECTRICAL CONNECTIONS



**WARNING: READ THESE ELECTRICAL SAFETY INSTRUCTIONS THOROUGHLY BEFORE CONNECTING THE PRODUCT TO THE MAINS SUPPLY.**

Before switching the product on, make sure that the voltage of your electricity supply is the same as that indicated on the rating plate. This product is designed to operate on 230VAC 50Hz. Connecting it to any other power source may cause damage.

This product may be fitted with a non-rewireable plug. If it is necessary to change the fuse in the plug, the fuse cover must be refitted. If the fuse cover becomes lost or damaged, the plug must not be used until a suitable replacement is obtained.

If the plug has to be changed because it is not suitable for your socket, or due to damage, it should be cut off and a replacement fitted, following the wiring instructions shown below. The old plug must be disposed of safely, as insertion into a mains socket could cause an electrical hazard.



**WARNING: THE WIRES IN THE POWER CABLE OF THIS PRODUCT ARE COLOURED IN ACCORDANCE WITH THE FOLLOWING CODE:  
BLUE = NEUTRAL    BROWN = LIVE**

If the colours of the wires in the power cable of this product do not correspond with the markings on the terminals of your plug, proceed as follows.

- The **Blue** wire must be connected to the terminal marked **N** or coloured **Black**.
- The **Brown** wire must be connected to the terminal marked **L** or coloured **Red**

**Plug must be BS1363/A approved.**

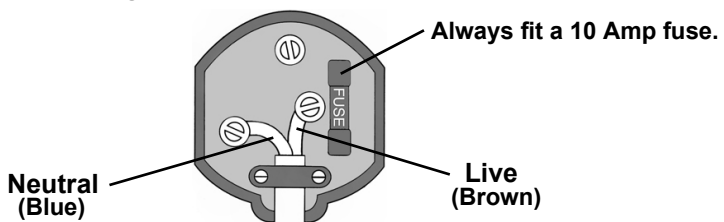

**Ensure that the outer sheath of the cable is firmly held by the clamp**

We strongly recommend that this machine is connected to the mains supply via a Residual Current Device (RCD)

If in any doubt, consult a qualified electrician. DO NOT attempt any repairs yourself.



**This symbol indicates that this is a Class II product, and does not require an earth connection.**

# OVERVIEW

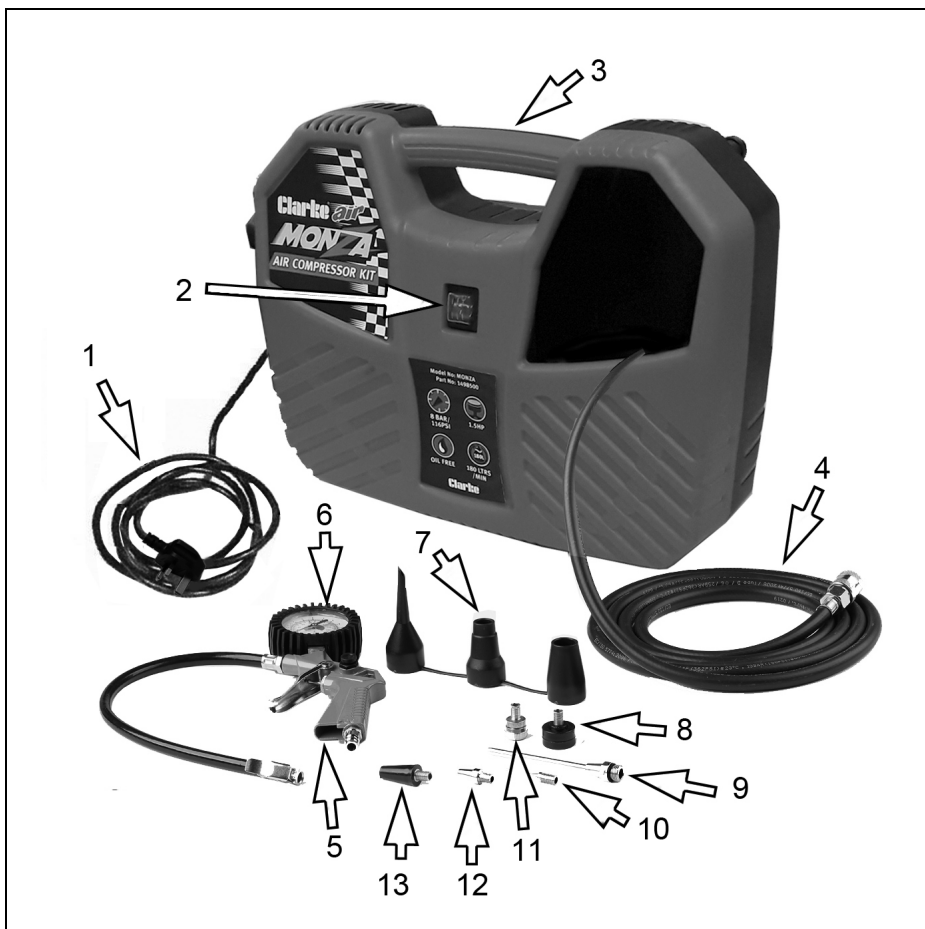

1	Power cable
2	On/Off switch
3	Carrying handle
4	Air hose with quick lock coupling
5	Compressed air pistol
6	Pressure gauge
7	Triple adaptor

8	Base for triple adaptor
9	Dust blowing nozzle
10	Basketball needle
11	Bicycle tyre adaptor
12	Balloon adaptor
13	Large adaptor



---

## PREPARATION FOR USE

---



**WARNING: BEFORE USING THE COMPRESSOR, MAKE SURE THAT YOU HAVE READ AND UNDERSTOOD THE SAFETY INSTRUCTIONS.**

---

### UNPACKING

After removing the compressor from its packaging, check that it has not been damaged in transit. Report any damage immediately to the dealer where the item was purchased.

### POSITIONING THE COMPRESSOR

1. Position the compressor near the point of work.
2. Avoid long air lines and extension cables if possible.
3. Make sure that the intake air is dry and dust free.
4. **DO NOT** use the compressor in a damp or wet room. The compressor should only be used with good ventilation and an ambient temperature from +5°C to 40°C). There must be no dust, acids, vapours, explosive gases or flammable gases in the room.
5. **NEVER** use the compressor in areas where work is conducted with sprayed water.

This compressor should be positioned on a stable, flat surface. If placed on a shelf or raised off the ground, it should be secured appropriately to prevent it from falling off during use.

6. **DO NOT** cover the compressor. Always position it with good all-round air ventilation.
7. When moving the compressor;
  - **ALWAYS** use the handle
  - **DO NOT** lift by (or place a strain on) the airline fittings or hoses
  - **ALWAYS** ensure it is switched off and disconnected from the power supply

### CONNECTION AND START UP

1. Ensure the ON/OFF switch is in the OFF "O" position, then plug in the compressor and switch ON at the mains supply.

2. Connect either the tool supplied, or another power tool of your choice using the plug-in connector. Connect the desired adaptor as shown.

3. Insert the nipple of the air tool into the quick-lock coupling of the air hose.

- The quick-lock sleeve will spring forward automatically connecting the accessory.

4. To disconnect the air tool, pull back the sleeve on the quick-lock coupling and remove the tool.

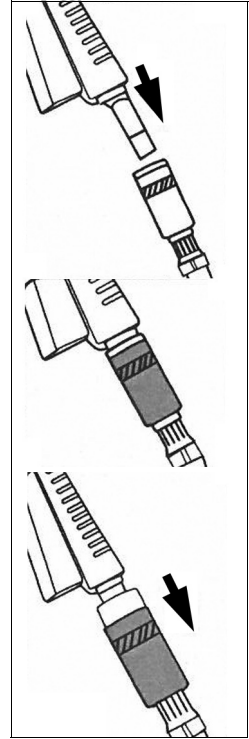

**WARNING: BEFORE CONNECTING ANY AIR TOOL, MAKE SURE YOU HAVE READ AND FULLY UNDERSTOOD THE MANUFACTURER'S INSTRUCTION BOOKLET FOR THE AIR TOOL BEING USED. ALSO ENSURE THAT THE AIR TOOL IS COMPATIBLE WITH THE COMPRESSOR AND HOSE SPECIFICATIONS.**

***Keep your hands well away from the air being expelled. Remember, compressed air is DANGEROUS***

# OPERATING

## SWITCHING ON AND OFF

1. To switch the compressor on, set the rocker switch to the ON "I" position.
2. If the task is completed run the attached air tool until no compressed air remains in the hose.
3. To switch the compressor off, set the rocker switch to the OFF "O" position

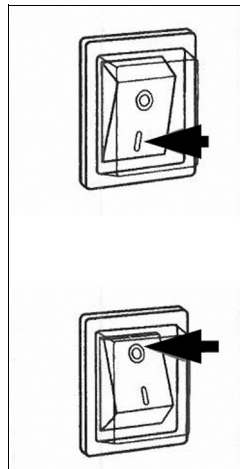

## INFLATING

### INFLATING TYRES

1. Attach the gun to the compressed air hose.

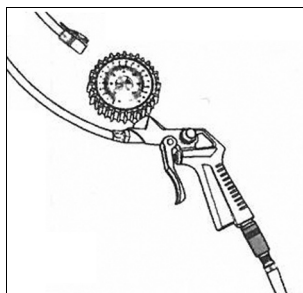

- When inflating tyres with normal "Schrader" valves, no adaptors need to be fitted to the rubber hose.
- Presta valves require the adaptor to be screwed onto the valve before attaching the rubber hose of the air gun.

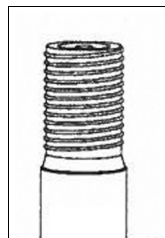

2. Connect the rubber hose of the air gun to the tyre by pressing the end of the hose onto the tyre valve while holding down the hose tab.

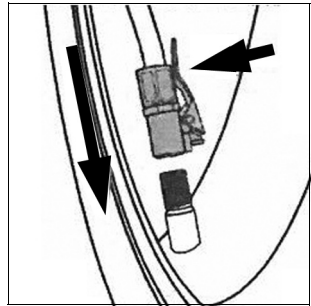

3. Release the valve connector. The hose will now be connected to the tyre valve.

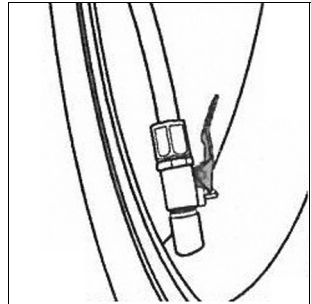

4. To inflate the tyre, hold down the trigger of the air gun.

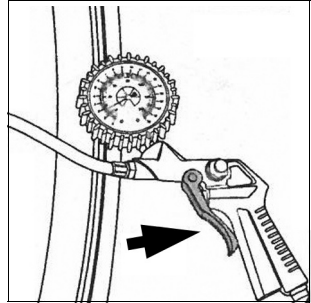

5. After a short time, release the trigger and check the tyre pressure by referring to the pressure gauge.
6. Avoid inflating the objects above the recommended inflation pressure. This could lead to damage and /or injuries.

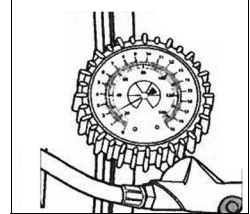

7. If the tyre pressure is too high, it can be reduced with the integrated release valve.
- Refer to the owners manual for the car/bicycle to confirm the correct tyre pressure required.

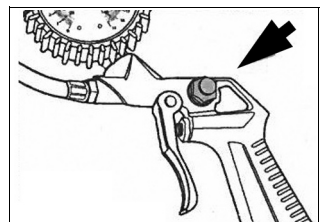

## INFLATING OTHER ITEMS

1. The compressor kit is supplied with a variety of adaptors that can be fitted to the rubber hose. These adaptors (shown on page 8) are suitable for different valves that are often used on inflatable items.

2. **Adaptor (11)** is used for footballs, basketballs etc.

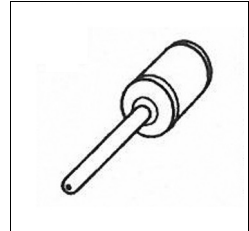

3. **Adaptor (12)** is used for rubber dinghies, inflatable small swimming pools and air beds.

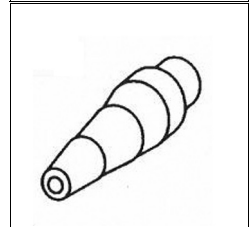

4. **Adaptor (8)** is used for bicycle tyres with "Presta" valves.

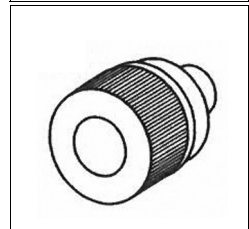

## ATTACHING INFLATION ADAPTORS TO THE RUBBER HOSE

1. Push the selected adaptor into the rubber hose while pressing the hose tab.

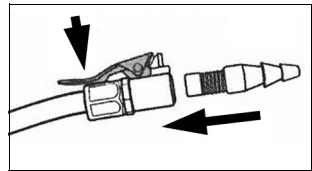

2. Once it is inserted, release the hose tab.

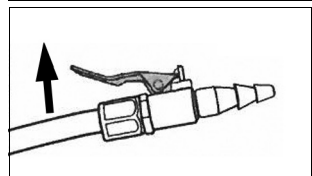

3. Turn the adaptor in a clockwise direction to secure it in place.

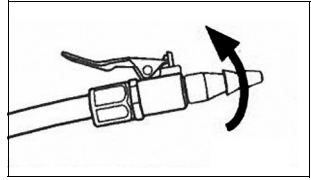

## BLOW GUN

1. To use the air gun as a blow gun, first unscrew and remove the rubber hose.

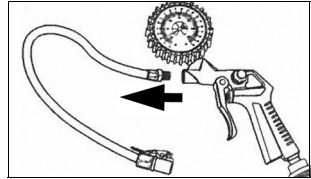

- The blower nozzle can then be screwed into the gun.

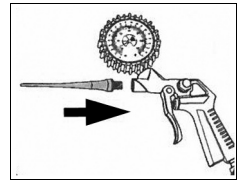

2. By varying the pressure on the trigger you can control the amount of compressed air released through the nozzle.

***IMPORTANT: The operator is advised to wear eye protection when using the blow gun. Take care not to blow dirt or other loose particles towards yourself or other persons.***

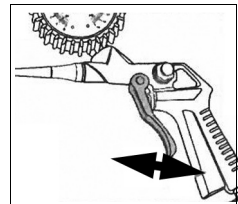

The blower nozzle adaptor is useful for blowing dust out of hollow spaces or hard to reach areas such as vents in electrical items or between the keys of a keyboard. It is also useful for cleaning soiled equipment.

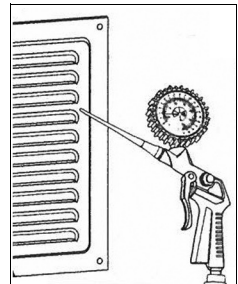

---

# MAINTENANCE

---

## CLEANING

Ensure the compressor is disconnected from the power supply before cleaning. Keep the compressor free of dirt and dust as far as possible. Wipe with a clean cloth or blow it down with compressed air at low pressure.

If cleaning is required, use a damp cloth and some soft soap. Never use cleaning agents or solvents as these may be aggressive to the plastic parts. Ensure that no water can get into the interior of the compressor.

**ALWAYS** disconnect the hose and any spraying tools from the compressor before cleaning.

## STORAGE

Store the power cable and hose inside the compressor storage compartment, taking care not to kink the hose or catch the leads.

Disconnect the mains plug and ventilate the compressor and any connected pneumatic tools. Store the compressor in a dry location.

---

# FAULTFINDING

---

SYMPTOM	PROBLEM	SOLUTION
The compressor does not start.	No power supply. Outside temperature is too low. Motor is overheated.	Check lack of power supply. Only use at acceptable environmental temperatures. Leave unit to cool down.
The compressor starts but there is no pressure	The non-return valve leaks. The seals are damaged	Return to your dealer for repair.
The compressor starts but the tools do not start.	The hose connections have a leak. A quick-lock coupling has a leak.	Check the hose and replace if necessary Check the coupling and replace if necessary.

In the event that any of the above situations arise, requiring the dismantling and overhaul of the compressor, contact your CLARKE International Service Department on 020-8988-7400.

# PARTS DIAGRAM

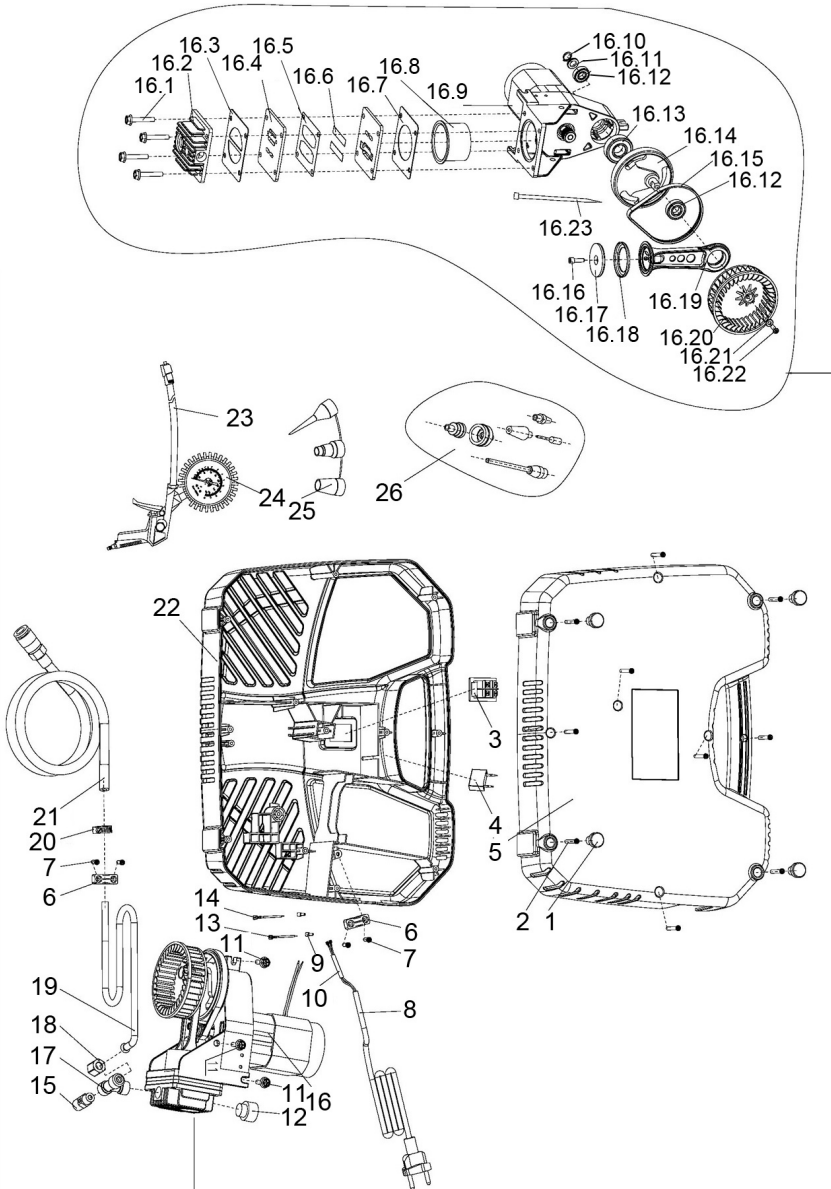

PUMP ASSEMBLY



## PARTS LIST

No	Description
1	Stopper
2	Screw
3	On/off switch
4	Capacitor
5	Lower cover
6	Cable clamp
7	Screw
8	Power cable and plug
9	Terminal
10	Cable gland
11	Screw
12	Air filter
13	Wire
14	Wire
15	Relief valve
16	Pump assembly
16.1	Screw
16.2	Cylinder head
16.3	Cylinder head gasket
16.4	Valve plate
16.5	Al. gasket
16.6	Valve
16.7	Valve plate gasket
16.8	Cylinder
16.9	Motor

No	Description
16.10	Circlip
16.11	Plain washer
16.12	Bearing
16.13	Bearing
16.14	Crankshaft
16.15	Belt
16.16	Screw
16.17	Piston
16.18	Piston ring
16.19	Connecting rod
16.20	Fan
16.21	Plain washer
16.22	Screw
16.23	Tie
17	3-way connector
18	Nut
19	Aluminium pipe
20	Hose clip
21	Hose
22	Upper cover
23	Inflating gun tube
24	Inflating gun
25	Plastic kits
26	Six-piece kits

---

## GUARANTEE

---

This CLARKE product is guaranteed against faulty manufacture for a period of 12 months from the date of purchase. Please keep your receipt as proof of purchase.

This guarantee is invalid if the product is found to have been abused or tampered with in any way, or not used for the purpose for which it was intended.

Faulty goods should be returned to their place of purchase, no product can be returned to us without prior permission.

This guarantee does not effect your statutory rights.

---

## ENVIRONMENTAL RECYCLING POLICY

---



By purchasing this product, the customer is taking on the obligation to comply with current WEEE regulations.

This means that this product must not be disposed of with general household waste. It must be disposed of according to the laws governing Waste Electrical and Electronic Equipment (WEEE) at a recognised disposal facility.

This product contains valuable raw materials. Metal products should be taken to your local civic amenity site for recycling of metal products.

# DECLARATION OF CONFORMITY



**Clarke<sup>®</sup>**  
**INTERNATIONAL**  
Fitzwilliam Hall, Fitzwilliam Place, Dublin 2

## DECLARATION OF CONFORMITY

This is an important document and should be retained.

We hereby declare that this product(s) complies with the following directive(s):

2006/42/EC *Machinery Directive*  
2014/30/EU *Electromagnetic Compatibility Directive*  
2011/65/EU *Restriction of Hazardous Substances (amended by EU/2015/863)*  
2000/14/EC *Noise Emissions Directive, (amended by 2005/88/EC)*

The following standards have been applied to the product(s):

EN 55014-1:2017, EN 55014-2:2015, EN 61000-3-2:2014, EN 61000-3-3:2015, EN 1012-1:2010,  
EN 60335-1:2012+A11:2014.

The technical documentation required to demonstrate that the product(s) meet(s) the requirement(s) of the aforementioned directive(s) has been compiled and is available for inspection by the relevant enforcement authorities.

The CE mark was first applied in: 2020

Signat:

  
J.A. Clarke  
Director

DOC (19-0185) MONZA Air Compressor K51 (r0) (NSJ)-0038 (2)

Page 2 of 2



**Clarke<sup>®</sup>**  
**INTERNATIONAL**  
Fitzwilliam Hall, Fitzwilliam Place, Dublin 2

## DECLARATION OF CONFORMITY

This is an important document and should be retained.

**Product Description:** Air compressor K51 230V  
**Model number(s):** MONZA  
**Serial / batch Number:** 1488500  
**Date of Issue:** 23/03/2021  
**Notified Body:** TÜV SÜD Industrie Service GmbH  
Westendstraße 199  
80686 MÜNCHEN  
Germany

### Technical Documentation Holder:

A.R. Pond  
Clarke International  
2a Shrubland Road  
London E10 7RB  
UK

**Conformity Assessment Procedure:** to 2000/14/EC Annex VI  
**Manufacturer:** Clarke International  
**Noise Related Value:** 1.1 kW  
**Measured Sound Power Level:** 94 dB  
**Guaranteed Sound Power Level:** 97 dB

DOC (19-0185) MONZA Air Compressor K51 (r0) (NSJ)-0038 (2)

Page 1 of 2

# A SELECTION FROM THE VAST RANGE OF

# Clarke®

## QUALITY PRODUCTS



### **AIR COMPRESSORS**

From DIY to industrial, Plus air tools, spray guns and accessories.

### **GENERATORS**

Prime duty or emergency standby for business, home and leisure.

### **POWER WASHERS**

Hot and cold, electric and engine driven - we have what you need

### **WELDERS**

Mig, Arc, Tig and Spot. From DIY to auto/industrial.

### **METALWORKING**

Drills, grinders and saws for DIY and professional use.

### **WOODWORKING**

Saws, sanders, lathes, mortisers and dust extraction.

### **HYDRAULICS**

Cranes, body repair kits, transmission jacks for all types of workshop use.

### **WATER PUMPS**

Submersible, electric and engine driven for DIY, agriculture and industry.

### **POWERTOOLS**

Angle grinders, cordless drill sets, saws and sanders.

### **STARTERS/CHARGERS**

All sizes for car and commercial use.

# **PARTS & SERVICE: 0208 988 7400**

## **Parts Enquiries**

**Parts@clarkeinternational.com**

## **Servicing & Technical Enquiries**

**Service@clarkeinternational.com**

**SALES: UK 01992 565333 or Export 00 44 (0)1992 565335**

**Clarke® INTERNATIONAL** Hemnall Street, Epping, Essex CM16 4LG  
[www.clarkeinternational.com](http://www.clarkeinternational.com)